

# Merlin Tools Ltd



## ER Collets

Individual and Sets

5 micron, 10 micron, 15-20 micron

Tapping and Through

Coolant Collets

Manufactured in Europe  
Distributed in the UK



ISO 9001:2008

**NEW  
PRODUCT  
LINES**

# ER 8 - Collets DIN 6499-B

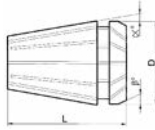

D	8.5
L	13.5
$\alpha$	8°
$\beta$	30°
CLAMPING RANGE	1.0-5.0
CLAMPING STEPS	0.5

100% Run-out checked

CLAMPING RANGE Ø	15-20 micron Precision	10 micron Super Precision	5 micron Ultra Precision
1.0 - 0.5	ER08 -0102	ER08 -0101	ER08 -010T
1.5 - 1.0	ER08 -0152	ER08 -0151	ER08 -015T
2.0 - 1.5	ER08 -0202	ER08 -0201	ER08 -020T
2.5 - 2.0	ER08 -0252	ER08 -0251	ER08 -025T
3.0 - 2.5	ER08 -0302	ER08 -0301	ER08 -030T
3.5 - 3.0	ER08 -0352	ER08 -0351	ER08 -035T
4.0 - 3.5	ER08 -0402	ER08 -0401	ER08 -040T
4.5 - 4.0	ER08 -0452	ER08 -0451	ER08 -045T
5.0 - 4.5	ER08 -0502	ER08 -0501	ER08 -050T

# ER 11 - Collets DIN 6499-B

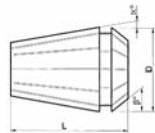

D	11.5
L	18
$\alpha$	8°
$\beta$	30°
CLAMPING RANGE	1.0-7.0
CLAMPING STEPS	0.5

5 micron,  
10 micron,  
15 - 20 micron

CLAMPING RANGE Ø	15-20 micron Precision	10 micron Super Precision	5 micron Ultra Precision
1.0 - 0.5	ER11 -0102	ER11 -0101	ER11 -010T
1.5 - 1.0	ER11 -0152	ER11 -0151	ER11 -015T
2.0 - 1.5	ER11 -0202	ER11 -0201	ER11 -020T
2.5 - 2.0	ER11 -0252	ER11 -0251	ER11 -025T
3.0 - 2.5	ER11 -0302	ER11 -0301	ER11 -030T
3.5 - 3.0	ER11 -0352	ER11 -0351	ER11 -035T
4.0 - 3.5	ER11 -0402	ER11 -0401	ER11 -040T
4.5 - 4.0	ER11 -0452	ER11 -0451	ER11 -045T
5.0 - 4.5	ER11 -0502	ER11 -0501	ER11 -050T
5.5 - 5.0	ER11 -0552	ER11 -0551	ER11 -055T
6.0 - 5.5	ER11 -0602	ER11 -0601	ER11 -060T
6.5 - 6.0	ER11 -0652	ER11 -0651	ER11 -065T
7.0 - 6.5	ER11 -0702	ER11 -0701	ER11 -070T

# ER 16 - Collets DIN 6499-B

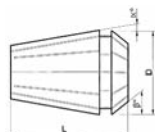

D	17
L	27.5
$\alpha$	8°
$\beta$	30°
CLAMPING RANGE	1.0-10.0
CLAMPING STEPS	1.0

3 Precision levels

CLAMPING RANGE Ø	15-20 micron Precision	10 micron Super Precision	5 micron Ultra Precision
1.0 - 0.5	ER16 -0102	ER16 -0101	ER16 -010T
2.0 - 1.0	ER16 -0202	ER16 -0201	ER16 -020T
3.0 - 2.0	ER16 -0302	ER16 -0301	ER16 -030T
4.0 - 3.0	ER16 -0402	ER16 -0401	ER16 -040T
5.0 - 4.0	ER16 -0502	ER16 -0501	ER16 -050T
6.0 - 5.0	ER16 -0602	ER16 -0601	ER16 -060T
7.0 - 6.0	ER16 -0702	ER16 -0701	ER16 -070T
8.0 - 7.0	ER16 -0802	ER16 -0801	ER16 -080T
9.0 - 8.0	ER16 -0902	ER16 -0901	ER16 -090T
10.0 - 9.0	ER16 -1002	ER16 -1001	ER16 -100T

# ER 20 - Collets DIN 6499-B

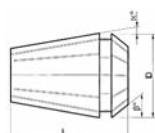

D	21
L	31.5
$\alpha$	8°
$\beta$	30°
CLAMPING RANGE	2.0-13.0
CLAMPING STEPS	1.0

Colour Coded Packaging

CLAMPING RANGE Ø	15-20 micron Precision	10 micron Super Precision	5 micron Ultra Precision
2.0 - 1.0	ER20 -0202	ER20 -0201	ER20 -020T
3.0 - 2.0	ER20 -0302	ER20 -0301	ER20 -030T
4.0 - 3.0	ER20 -0402	ER20 -0401	ER20 -040T
5.0 - 4.0	ER20 -0502	ER20 -0501	ER20 -050T
6.0 - 5.0	ER20 -0602	ER20 -0601	ER20 -060T
7.0 - 6.0	ER20 -0702	ER20 -0701	ER20 -070T
8.0 - 7.0	ER20 -0802	ER20 -0801	ER20 -080T
9.0 - 8.0	ER20 -0902	ER20 -0901	ER20 -090T
10.0 - 9.0	ER20 -1002	ER20 -1001	ER20 -100T
11.0 - 10.0	ER20 -1102	ER20 -1101	ER20 -110T
12.0 - 11.0	ER20 -1202	ER20 -1201	ER20 -120T
13.0 - 12.0	ER20 -1302	ER20 -1301	ER20 -130T

**Merlin** Tools Ltd

Quality  
Precision  
Performance

Made in Europe  
Distributed in the UK



# ER 25 - Collets DIN 6499-B

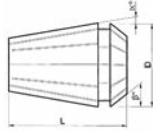

3 Precision levels

D	26
L	34
α	8°
β	30°
CLAMPING RANGE	2.0-16.0
CLAMPING STEPS	1.0

CLAMPING RANGE Ø	15-20 micron Precision	10 micron Super Precision	5 micron Ultra Precision
2.0 - 1.0	ER25 -0202	ER25 -0201	ER25 -020T
3.0 - 2.0	ER25 -0302	ER25 -0301	ER25 -030T
4.0 - 3.0	ER25 -0402	ER25 -0401	ER25 -040T
5.0 - 4.0	ER25 -0502	ER25 -0501	ER25 -050T
6.0 - 5.0	ER25 -0602	ER25 -0601	ER25 -060T
7.0 - 6.0	ER25 -0702	ER25 -0701	ER25 -070T
8.0 - 7.0	ER25 -0802	ER25 -0801	ER25 -080T
9.0 - 8.0	ER25 -0902	ER25 -0901	ER25 -090T
10.0 - 9.0	ER25 -1002	ER25 -1001	ER25 -100T
11.0 - 10.0	ER25 -1102	ER25 -1101	ER25 -110T
12.0 - 11.0	ER25 -1202	ER25 -1201	ER25 -120T
13.0 - 12.0	ER25 -1302	ER25 -1301	ER25 -130T
14.0 - 13.0	ER25 -1402	ER25 -1401	ER25 -140T
15.0 - 14.0	ER25 -1502	ER25 -1501	ER25 -150T
16.0 - 15.0	ER25 -1602	ER25 -1601	ER25 -160T

# ER 32 - Collets DIN 6499-B

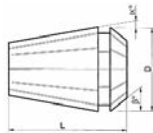

100% Run-out checked

D	33
L	40
α	8°
β	30°
CLAMPING RANGE	3.0-20.0
CLAMPING STEPS	1.0

CLAMPING RANGE Ø	15-20 micron Precision	10 micron Super Precision	5 micron Ultra Precision
3.0 - 2.0	ER32 -0302	ER32 -0301	ER32 -030T
4.0 - 3.0	ER32 -0402	ER32 -0401	ER32 -040T
5.0 - 4.0	ER32 -0502	ER32 -0501	ER32 -050T
6.0 - 5.0	ER32 -0602	ER32 -0601	ER32 -060T
7.0 - 6.0	ER32 -0702	ER32 -0701	ER32 -070T
8.0 - 7.0	ER32 -0802	ER32 -0801	ER32 -080T
9.0 - 8.0	ER32 -0902	ER32 -0901	ER32 -090T
10.0 - 9.0	ER32 -1002	ER32 -1001	ER32 -100T
11.0 - 10.0	ER32 -1102	ER32 -1101	ER32 -110T
12.0 - 11.0	ER32 -1202	ER32 -1201	ER32 -120T
13.0 - 12.0	ER32 -1302	ER32 -1301	ER32 -130T
14.0 - 13.0	ER32 -1402	ER32 -1401	ER32 -140T
15.0 - 14.0	ER32 -1502	ER32 -1501	ER32 -150T
16.0 - 15.0	ER32 -1602	ER32 -1601	ER32 -160T
17.0 - 16.0	ER32 -1702	ER32 -1701	ER32 -170T
18.0 - 17.0	ER32 -1802	ER32 -1801	ER32 -180T
19.0 - 18.0	ER32 -1902	ER32 -1901	ER32 -190T
20.0 - 19.0	ER32 -2002	ER32 -2001	ER32 -200T

# ER 40 - Collets DIN 6499-B

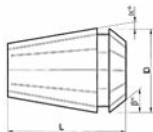

5 micron,  
10 micron,  
15 - 20 micron

D	41
L	46
α	8°
β	30°
CLAMPING RANGE	3.0-26.0
CLAMPING STEPS	1.0

CLAMPING RANGE Ø	15-20 micron Precision	10 micron Super Precision	5 micron Ultra Precision
3.0 - 2.0	ER40 -0302	ER40 -0301	ER40 -030T
4.0 - 3.0	ER40 -0402	ER40 -0401	ER40 -040T
5.0 - 4.0	ER40 -0502	ER40 -0501	ER40 -050T
6.0 - 5.0	ER40 -0602	ER40 -0601	ER40 -060T
7.0 - 6.0	ER40 -0702	ER40 -0701	ER40 -070T
8.0 - 7.0	ER40 -0802	ER40 -0801	ER40 -080T
9.0 - 8.0	ER40 -0902	ER40 -0901	ER40 -090T
10.0 - 9.0	ER40 -1002	ER40 -1001	ER40 -100T
11.0 - 10.0	ER40 -1102	ER40 -1101	ER40 -110T
12.0 - 11.0	ER40 -1202	ER40 -1201	ER40 -120T
13.0 - 12.0	ER40 -1302	ER40 -1301	ER40 -130T
14.0 - 13.0	ER40 -1402	ER40 -1401	ER40 -140T
15.0 - 14.0	ER40 -1502	ER40 -1501	ER40 -150T
16.0 - 15.0	ER40 -1602	ER40 -1601	ER40 -160T
17.0 - 16.0	ER40 -1702	ER40 -1701	ER40 -170T
18.0 - 17.0	ER40 -1802	ER40 -1801	ER40 -180T
19.0 - 18.0	ER40 -1902	ER40 -1901	ER40 -190T
20.0 - 19.0	ER40 -2002	ER40 -2001	ER40 -200T
21.0 - 20.0	ER40 -2102	ER40 -2101	ER40 -210T
22.0 - 21.0	ER40 -2202	ER40 -2201	ER40 -220T
23.0 - 22.0	ER40 -2302	ER40 -2301	ER40 -230T
24.0 - 23.0	ER40 -2402	ER40 -2401	ER40 -240T
25.0 - 24.0	ER40 -2502	ER40 -2501	ER40 -250T
26.0 - 25.0	ER40 -2602	ER40 -2601	ER40 -260T



Quality  
Precision  
Performance

Made in Europe  
Distributed in the UK



# Precision Collets DIN 6499-B

15 - 20 micron	10 micron	5 micron
<b>ER 8 - Collet set, 9 pieces <math>\varnothing</math> 1-5mm in 0.5mm increment</b>		
ER08 - SET 2	ER08 - SET 1	ER08 - SETT
<b>ER 11 - Collet set, 13- pieces <math>\varnothing</math> 1-7mm in 0.5mm increment</b>		
ER11 - SET 2	ER11 - SET 1	ER11 - SETT
<b>ER 16 - Collet set, 10 pieces <math>\varnothing</math> 1-10mm in 1.0mm increment</b>		
ER16 - SET 2	ER16 - SET 1	ER16 - SETT
<b>ER 20 - Collet set, 12 pieces <math>\varnothing</math> 2-13mm in 1.0mm increment</b>		
ER20 - SET 2	ER20 - SET 1	ER20 - SETT
<b>ER 25 - Collet set, 15 pieces <math>\varnothing</math> 2-16mm in 1.0mm increment</b>		
ER25 - SET 2	ER25 - SET 1	ER25 - SETT
<b>ER 32 - Collet set, 18 pieces <math>\varnothing</math> 3-20mm in 1.0mm increment</b>		
ER32 - SET 2	ER32 - SET 1	ER32 - SETT
<b>ER 40 - Collet set, 23 pieces <math>\varnothing</math> 4-26mm in 1.0mm increment</b>		
ER40 - SET 2	ER40 - SET 1	ER40 - SETT



**Merlin** Tools Ltd

Quality  
Precision  
Performance

Made in Europe  
Distributed in the UK



# ER Tapping Collets DIN 371 & 376 - 10 micron

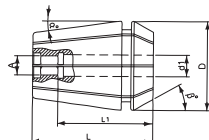

For taps to be used in standard ER chucks as well as tapping chucks. Hold taps according to the specific shank and square size.

	PART NUMBER	d1	DIN371	DIN376	SQUARE	L1
ER16 D=16.5/L=27.5	ERT16 -045	4.5	M4	M6	3.55	18
	ERT16 -060	6	M4,5-M5-M6	M8	5	18
ER20 D=20.5/L=32.5	ERT20 -045	4.5	M4	M6	3.55	18
	ERT20 -060	6	M4,5-M5-M6	M8	5	18
	ERT20 -080	8	M8	M11	6.3	22
	ERT20 -090	9	M9	M12	7.1	22
	ERT20 -100	10	M10		8	25
ER25 D=25.5/L=34	ERT25 -045	4.5	M4	M6	3.55	18
	ERT25 -060	6	M4,5-M5-M6	M8	5	18
	ERT25 -080	8	M8	M11	6.3	22
	ERT25 -090	9	M9	M12	7.1	22
	ERT25 -100	10	M10		8	25
	ERT25 -110	11		M14	9	25
	ERT25 -120	12	M12	M16	9	25
ER32 D=32.5/L=40	ERT32 -045	4.5	M4	M6	3.55	18
	ERT32 -060	6	M4,5-M5-M6	M8	5	18
	ERT32 -080	8	M8	M11	6.3	22
	ERT32 -090	9	M9	M12	7.1	22
	ERT32 -100	10	M10		8	25
	ERT32 -110	11		M14	9	25
	ERT32 -120	12	M12	M16	9	25
	ERT32 -140	14		M18	11.2	25
	ERT32 -160	16		M20	12.5	25
	ER40 D=40.5/L=46	ERT40 -060	6	M4,5-M5-M6	M8	5
ERT40 -080		8	M8	M11	6.3	22
ERT40 -090		9	M9	M12	7.1	22
ERT40 -100		10	M10		8	25
ERT40 -110		11		M14	9	25
ERT40 -120		12	M12	M16	9	25
ERT40 -140		14		M18	11.2	25
ERT40 -160		16		M20	12.5	25
ERT40 -180		18		M22-M24	14.5	33

# ER Through Coolant Precision Collets DIN 6499-B

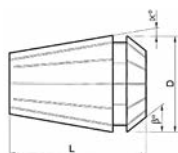

For internal coolant tools. Enables internal coolant tools to be used in standard ER toolholders.

The clamping capacity is only 0.5mm down to the nominal diameter (and not 1.0mm - clamping as the standard ER range)

	CLAMPING RANGE Ø	15-20 micron General Purpose	10 micron Higher Accuracy	5 micron Top Accuracy
ER 16 D=17 / L=27.5	6	ERC16 -0602	ERC16 -0601	ERC16 -060T
	8	ERC16 -0802	ERC16 -0801	ERC16 -080T
	10	ERC16 -1002	ERC16 -1001	ERC16 -100T
ER 20 D=21 / L=32.5	6	ERC20 -0602	ERC20 -0601	ERC20 -060T
	8	ERC20 -0802	ERC20 -0801	ERC20 -080T
	10	ERC20 -1002	ERC20 -1001	ERC20 -100T
	12	ERC20 -1202	ERC20 -1201	ERC20 -120T
ER 25 D=26 / L=34	6	ERC25 -0602	ERC25 -0601	ERC25 -060T
	8	ERC25 -0802	ERC25 -0801	ERC25 -080T
	10	ERC25 -1002	ERC25 -1001	ERC25 -100T
	12	ERC25 -1202	ERC25 -1201	ERC25 -120T
	14	ERC25 -1402	ERC25 -1401	ERC25 -140T
	16	ERC25 -1602	ERC25 -1601	ERC25 -160T
ER 32 D=33 / L=40	6	ERC32 -0602	ERC32 -0601	ERC32 -060T
	8	ERC32 -0802	ERC32 -0801	ERC32 -080T
	10	ERC32 -1002	ERC32 -1001	ERC32 -100T
	12	ERC32 -1202	ERC32 -1201	ERC32 -120T
	14	ERC32 -1402	ERC32 -1401	ERC32 -140T
	16	ERC32 -1602	ERC32 -1601	ERC32 -160T
	18	ERC32 -1802	ERC32 -1801	ERC32 -180T
	20	ERC32 -2002	ERC32 -2001	ERC32 -200T
ER 40 D=41 / L=46	6	ERC40 -0602	ERC40 -0601	ERC40 -060T
	8	ERC40 -0802	ERC40 -0801	ERC40 -080T
	10	ERC40 -1002	ERC40 -1001	ERC40 -100T
	12	ERC40 -1202	ERC40 -1201	ERC40 -120T
	14	ERC40 -1402	ERC40 -1401	ERC40 -140T
	16	ERC40 -1602	ERC40 -1601	ERC40 -160T
	18	ERC40 -1802	ERC40 -1801	ERC40 -180T
	20	ERC40 -2002	ERC40 -2001	ERC40 -200T
	25	ERC40 -2502	ERC40 -2501	ERC40 -250T



Quality  
Precision  
Performance

Made in Europe  
Distributed in the UK



# ER 50 - Collets DIN 6499-B

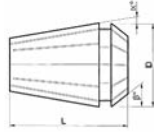

100% Run Out Checked

D	52
L	60
$\alpha$	8°
$\beta$	30°
CLAMPING RANGE	12.0-34.0
CLAMPING STEPS	2.0

RANGE Ø	Precision
12.0 - 10.0	ER50 -1202
14.0 - 12.0	ER50 -1402
16.0 - 14.0	ER50 -1602
18.0 - 16.0	ER50 -1802
20.0 - 18.0	ER50 -2002
22.0 - 20.0	ER50 -2202
24.0 - 22.0	ER50 -2402
25.0 - 23.0	ER50 -2502
26.0 - 24.0	ER50 -2602
28.0 - 26.0	ER50 -2802
30.0 - 28.0	ER50 -3002
32.0 - 30.0	ER50 -3202
34.0 - 32.0	ER50 -3402

## ER 50 - Collet set, 12 pieces ø 12-34mm in 2.0mm increment



ER50 -SET 2

15 - 20 micron  
General Purpose

✓ **Extremely Competitive Pricing**

✓ **Ex Stock Delivery on All Collets**

**Locknuts • Pullstuds • Spanners**  
**Straight Shank Toolholders Collet chucks**  
**Tapping chucks • Collet chuck sets**



**Call us now for your  
FREE 200 page Product Catalogue!**

**01509 610300**

**Solid Carbide Endmills • Drills including 3xD - 5xD - 8xD**  
**Solid Carbide Threadmills ISO Metric & NPT**  
**Izar HSSCo & Izarmax ASP52 Endmills • Machine Taps HSSCo & ASP2023**  
**Carbide Rotary Burrs • Collets & Chucks**